

## FERRO Klima

# THE CLIMATE-PROTECTIVE FOR A HEALTHY ENVIRONMENT.

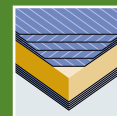

5-ply faces

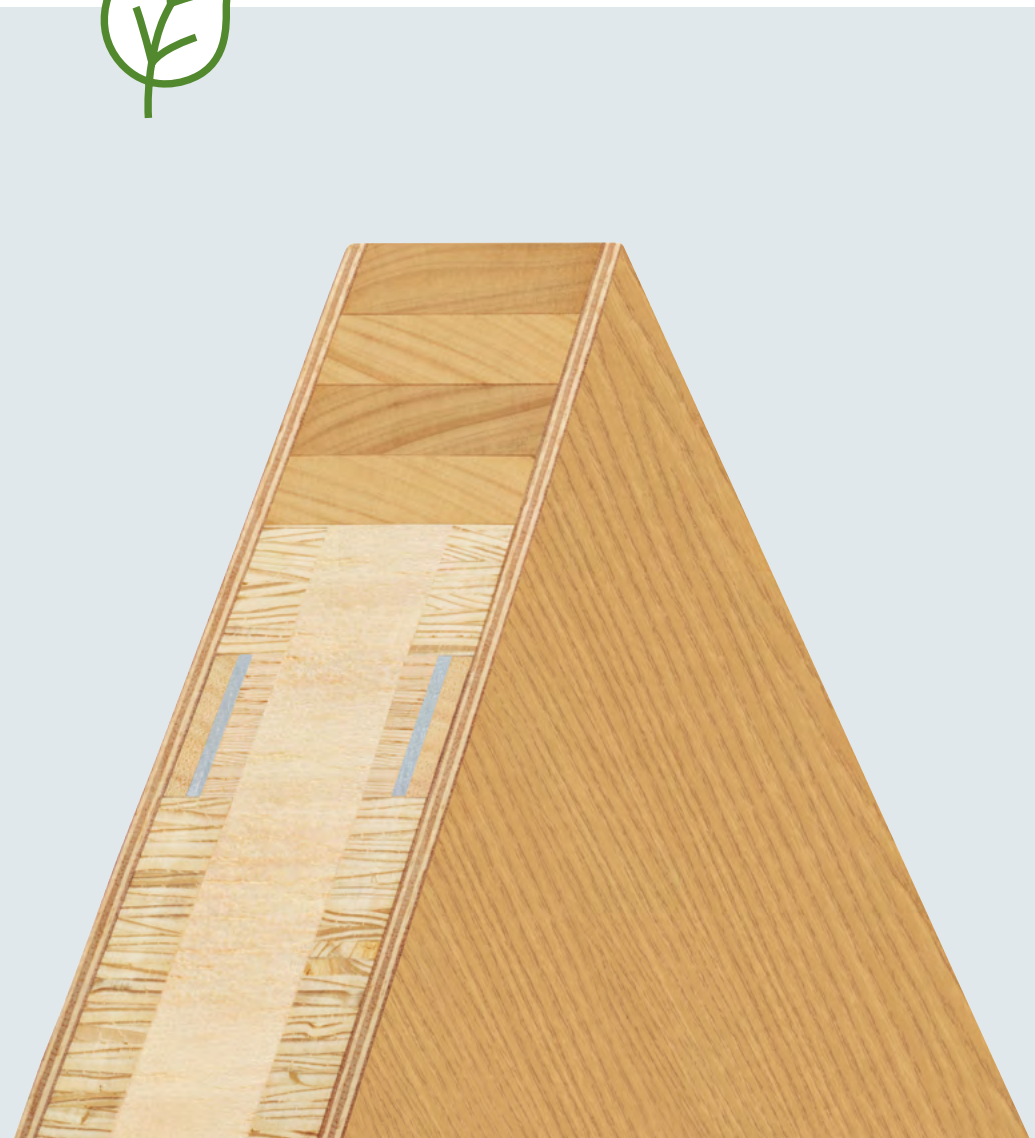

Exterior grade  
MDF faces



Flat steel  
stabilizer

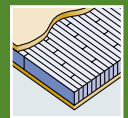

Laminated  
core



Robust  
construction

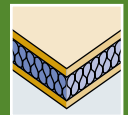

Ecological  
solid timber  
insulation



# TECHNICAL DETAILS

<b>1/8 DOOR FRAME</b>			
<b>1 Framing/Timber</b>	Finger-jointed and laminated timber framing.		
<b>8 Flat steel stabilizer</b>	Lock-side patented flat steel stabilizer – thermally separated and sound insulated – to absorb tractive and shearing forces. Flat iron straps are glued and friction-locked with the framework.		
<b>Frame width/Options to shorten/Glass apertures</b>	Thickness of door blank 68/78 mm		
	Frame width in mm	can be trimmed by	
	Top	155	110*
	Side	lock-side 70/hinge-side 155	lock-side 25*/hinge-side 110*
	Bottom	155	120*
Minimum distance for glass apertures on all 4 sides: 180 mm. The frame width corresponds to the shortening dimension. When trimmed by a maximum at the bottom (120 mm), a single rebate (max. 18 mm) and/or fitting of drop down seal is possible.			
<b>2 INNER LAYER</b>			
<b>Construction</b>	Quality-proven with long-term experience - Sandwich construction of laminated core (pine) and ecological solid timber insulation - Well surface stability through vertically aligned annual rings		
<b>Bonding</b>	Free of formaldehyde		
<b>3-7 COVER BOARD</b>			
<b>Bonding</b>	AW bonding according to DIN 68705 T2 temperature resistant up to 130° - 5 layers (noble veneer, longitudinal) - 3 layers (cross grained veneer) = can be veneered individually Full-surface bonding with the overall construction		
<b>EXTERNAL DOOR BLANK</b>			
<b>Model/finish</b>	Cut and sanded		

\* with a max. rebate of 30 mm

## EXAMINATIONS AND TESTS

<b>LENGTH IN MM</b>	2,110/2,240/2,470
<b>WIDTH IN MM</b>	950/1,050/1,150
<b>THICKNESS IN MM</b>	68 (66*) / 78 (76*)
<b>DIFFERENT CLIMATE TESTING</b>	
DIN EN 1121 : 2000-09	test climate „c“
DIN EN 1121 : 2000-09	test climate „d“
DIN EN 1121 : 2000-09	test climate „e“
<b>TOLERANCE CLASSES (by using three hinges)</b>	
DIN EN 12219 : 2000-6	3
<b>THERMAL TRANSFER COEFFICIENT</b>	
U-value (W/m²K) according to EnEV	1.04/0.95
<b>SOUND INSULATION</b>	
DIN EN ISO 717-1 R <sub>w</sub> ,[dB]	32-37
<b>BURGLAR-RESISTANCE</b>	
DIN ENV 1627 : 1999-04	RC2/RC3
<b>WEIGHT: 2,240 X 1,050 MM KG/PIECE</b>	65/74

\* cross veneered

**PfB** Prüfzentrum für Bauelemente  
Dipl.-Ing. (FH) Rüdiger Müller  
Lehrerweg 24 • D-82011 Steingaden (bei Törsching)

## PRODUCT RANGE

FERRO KLIMA – 68 MM / 78 MM							
Length in mm	2,110 (1,880*)		2,240 (2,010*)			2,470 (2,240*)	
Width in mm	950	1,050	950	1,050	1,150	1,050	1,150
Mahogany	▲	▲	▲	▲	▲	■	■
Okoume	▲	▲	▲	▲	▲	■	■
Meranti	▲	▲	▲	▲	▲	■	■
Oak	▲	▲	▲	▲	▲	■	■
Pine	▲	▲	▲	▲	▲	■	■
Spruce	▲	▲	▲	▲	▲	■	■
Larch	▲	▲	▲	▲	▲	■	■
Paint-grade	▲	▲	▲	▲	▲	■	■
MDF exterior	▲	▲	▲	▲	▲	■	■
FERRO KLIMA – 66 MM / 76 MM							
Length in mm	2,110 (1,880*)		2,240 (2,010*)			2,470 (2,240*)	
Width in mm	950	1,050	950	1,050	1,150	1,050	1,150
Cross grained PV	▲	▲	▲	▲	▲	■	■

\* minimal dimension ■ order-based production ▲ available in 5 working days PV = peeled veneer face

All veneer surfaces = cut veneer or fine-line

Further dimensions, sizes and facings on request.



**Any Questions?** Info-Hotline: +49 8026 92538-11 [www.moralt-ag.com](http://www.moralt-ag.com)  
Moralt AG, Obere Tiefenbachstraße 1, 83734 Hausham, Phone: +49 8026 92538-0, Fax: +49 8026 92538-40,  
E-mail: [info@moralt-ag.de](mailto:info@moralt-ag.de)

This information is according to the present state of knowledge and does not represent an assurance of properties. Existing laws and regulations are to be followed by the recipient of our products at his own responsibility. All information refers solely to products by Moralt AG.

## FERRO Klima

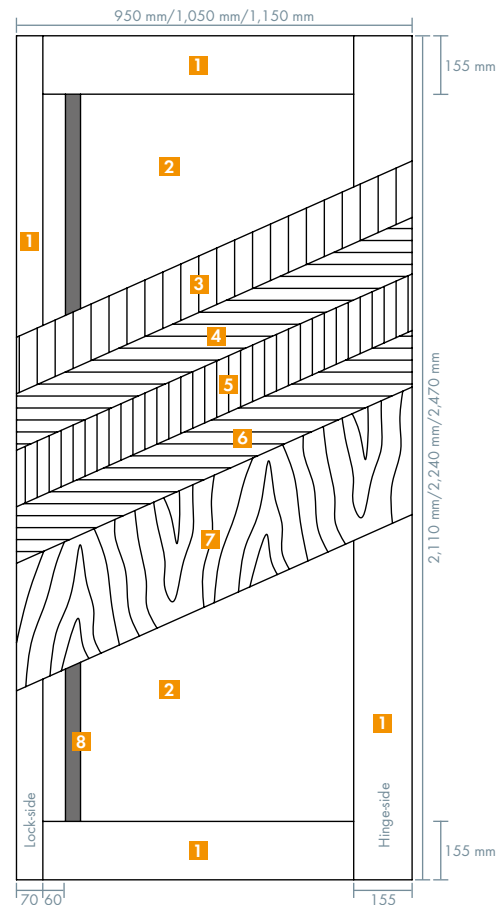

- 1** Solid timber frame
- 2** Laminated core layer
- 3-7** Cover board
- 8** Flat steel stabilizer
- 9** Heat-insulating light-weight wood

### Cross-section view lock-side

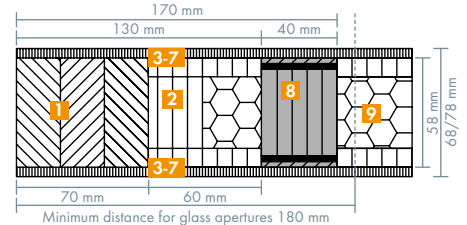

### Cross-section view hinge-side

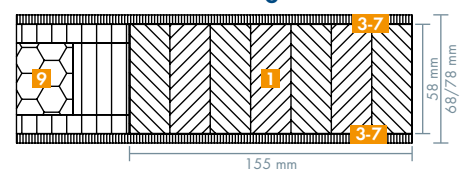

### CNC-processing service

All types may be delivered CNC processed.

### Despatch of single cargo

Direct delivery of a single piece to the manufacturer is possible.

Profi-Net timber distributor