

## FERRO KlassikPlus

# THE BESTSELLER FOR SECURITY AND COMFORT.

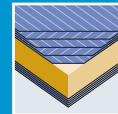

New  
decors and  
sizes



5-ply faces



Exterior grade  
MDF faces



Flat steel  
stabilizer

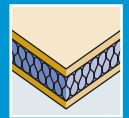

PU hard  
foam core



Robust  
construction

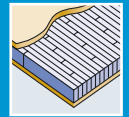

Laminated  
core

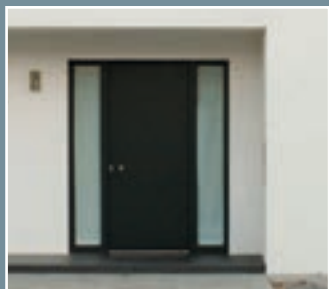

# TECHNICAL DETAILS

<b>1/8 DOOR FRAME</b>			
<b>1 Framing/timber</b>	Finger-jointed and laminated timber framing.		
<b>8 Flat steel stabilizer</b>	Lock-side flat steel stabilizer – thermally separated and sound insulated – to absorb tractive and shearing forces. Stabilizers are glued and friction-locked with the framework.		
<b>Frame width/Options to shorten/Glass apertures</b>	Thickness of door blank 68/78/88/98 mm		
	Frame width in mm	can be trimmed by	
	Top	127	75*
	Side	lock-side 80/hinge-side 127	lock-side 25*/hinge-side 75*
	Bottom	127	85*
Minimum distance for glass apertures on all 4 sides: 180 mm. The entrance width corresponds to the shortening dimension. When cut to minimum length at the bottom (85mm), a single rebate (max. 18 mm) or fitting of drop down seal is possible.			
<b>2 INNER LAYER</b>			
<b>Construction</b>	- Sandwich construction of laminated core (spruce) and HCFC-free and environmentally compatible PU hard foam		
<b>Bonding</b>	- Surface stability through vertically aligned annual rings		
<b>Bonding</b>	Free of formaldehyde		
<b>3-7 COVER BOARD</b>			
<b>Bonding</b>	AW bonding according to DIN 68705 -2 - 5 layers (noble veneer, longitudinal) - 3 layers (cross grained veneer) = can be veneered individually Full-surface bonding with the overall construction		
<b>EXTERNAL DOOR BLANK</b>			
<b>Model/finish</b>	Cut and sanded		

\* with a max. rebate of 30 mm

## CERTIFICATION

<b>LENGTH IN MM</b>	2,110/2,240/2,370/2,470/2,600			
<b>WIDTH IN MM</b>	950/1,050/1,150/1,230			
<b>THICKNESS IN MM</b>	68	78	88	98
<b>DIFFERENT CLIMATE TESTING</b>				
DIN EN 1121 : 2000-09	test climate c, d, e			
<b>TOLERANCE CLASSES (by using three hinges)</b>				
DIN EN 12219 : 2000-6	3**			
<b>THERMAL TRANSFER COEFFICIENT 2.240 X 1.050 MM</b>				
U-value (W/m²K) DIN EN ISO 10077-2 : 2012-06	0,95	0,84	0,73	0,65
<b>SOUND INSULATION</b>				
DIN EN ISO 717-1 R <sub>w</sub> (dB)	30/38*			
<b>BURGLAR-RESISTANCE</b>				
DIN EN 1627 : 2011-09	RC2/RC3**			
<b>WEIGHT: 2,240 X 1,050 MM KG/PIECE</b>	62	70	72	78

\* model FERRO KlassikPlus Akustik on request  
\*\* certified upto height 2,470 mm



## PRODUCT RANGE

FERRO KLASSIKPLUS – 68 MM / 78 MM / 88 MM / 98 MM										
Length in mm	2,110 (1,950*)		2,240 (2,080*) / 2,370 (2,210*)		2,470 (2,310*) / 2,600 (2,440*)					
Width in mm	950	1,050	950	1,050	1,150	1,230	950	1,050	1,150	1,230
Mahogany	▲	○	▲	○	▲	▲	▲	▲	▲	▲
Okoumé/Gabun	○	○	▲	○	▲	▲	▲	▲	▲	▲
Meranti	▲	▲	▲	▲	▲	▲	▲	▲	▲	▲
Oak	▲	○	▲	○	▲	▲	▲	▲	▲	▲
Knotty oak	▲	▲	▲	▲	▲	▲	▲	▲	▲	▲
Knotty oak 3.5 mm**	▲	▲	▲	▲	▲	▲	▲	▲	▲	▲
Rustic knotty oak	▲	▲	▲	▲	▲	▲	▲	▲	▲	▲
Pine	▲	▲	▲	▲	▲	▲	▲	▲	▲	▲
Spruce	▲	▲	▲	▲	▲	▲	▲	▲	▲	▲
Larch	▲	▲	▲	▲	▲	▲	▲	▲	▲	▲
Knotty larch	▲	▲	▲	▲	▲	▲	▲	▲	▲	▲
White fir	▲	▲	▲	▲	▲	▲	▲	▲	▲	▲
Paint-grade	○	○	▲	○	▲	▲	○	▲	▲	▲
MDF Exterior	○	○	○	○	▲	▲	○	▲	▲	▲
CPL	▲	▲	▲	▲	▲	▲	▲	▲	▲	▲
FERRO KLASSIKPLUS – 66 MM / 76 MM / 86 MM / 96 MM										
Length in mm	2,110 (1,950*)		2,240 (2,080*) / 2,370 (2,210*)		2,470 (2,310*) / 2,600 (2,440*)					
Width in mm	950	1,050	950	1,050	1,150	1,230	950	1,050	1,150	1,230
Cross grained PV	▲	○	▲	▲	▲	▲	▲	▲	▲	▲

\* minimal dimension \*\* cross-grain ○ in stock up to 68 mm ▲ available in 5 working days PV = peeled veneer face  
All veneer surfaces = cut veneer or fine-line

Further dimensions, sizes and facings on request.



**Any Questions?** Info-Hotline: +49 8026 92538-11 [www.moralt-ag.com](http://www.moralt-ag.com)  
Moralt AG, Obere Tiefenbachstraße 1, 83734 Hausham, Phone: +49 8026 92538-0, Fax: +49 8026 92538-40,  
E-Mail: [vertrieb@moralt-ag.de](mailto:vertrieb@moralt-ag.de)

This information is according to the present state of knowledge and does not represent an assurance of properties. Existing laws and regulations are to be followed by the recipient of our products at his own responsibility. All information refers solely to products by Moralt AG.

## FERRO KlassikPlus

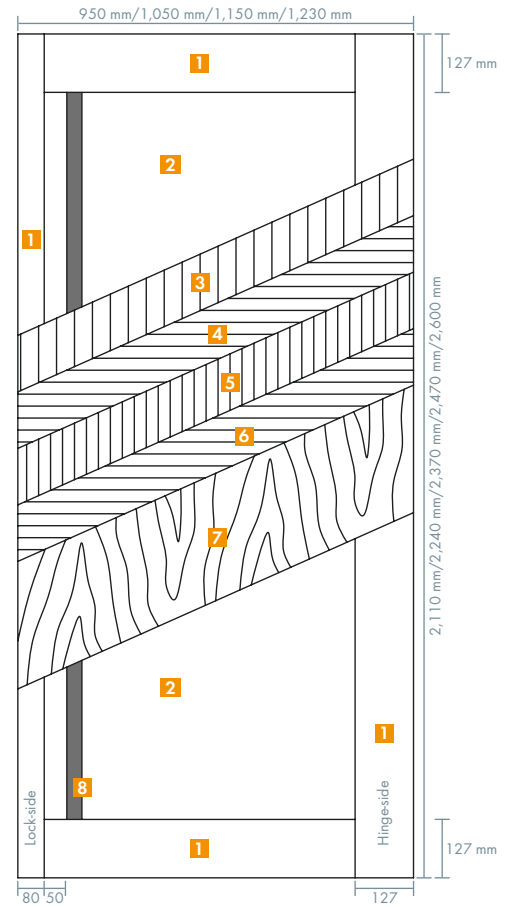

- 1** Framing/timber
- 2** Inner core layer in sandwich system/PU
- 3-7** Cover board
- 8** Flat steel stabilizer
- 9** PU hard foam

### Cross-section view lock-side

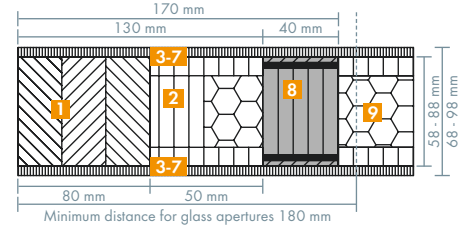

### Cross-section view hinge side

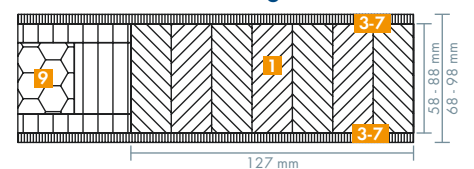

### Despatch of single cargo

Direct delivery of a single piece to the manufacturer is possible.

### CNC-processing service

All types may be delivered CNC processed.